

REPORT OF GROUP DIRECTOR, NEIGHBOURHOODS AND HOUSING		
LICENSING SUB-COMMITTEE: 26 October 2021	Classification DECISION	Enclosure
TEMPORARY EVENT NOTICE – COUNTER NOTICE: The Munch, Ground Floor, 148 Shoreditch High Street , London, E1 6JE	Ward Hoxton East & Shoreditch	

1. SUMMARY

- 1.1 The Police have given the Licensing Authority and the premises user notice of objection to Temporary Event Notices for an event to be held on **30/10/2021** from **02:00am** finishing on **01/11/2021** at **05:00am** at above premises. The Licensing Authority must hold a hearing to decide whether or not to allow the event to proceed.

2. RECOMMENDATION

- 2.1 That the Licensing Sub-Committee consider the issuing of counter notices if it is satisfied that any of the licensing objectives would be undermined if the premises were to be used in accordance with the temporary event notice.

3. TEMPORARY EVENT NOTICES - BACKGROUND

- 3.1 Part 5 the Licensing Act 2003 permits small scale events to take place at which alcohol will be sold or other licensable activities will take place. The numbers attending the event must not exceed 499 people and there are restrictions on the number of events that can be held per year.
- 3.2 The individual must give notice of her/his intention to hold the event to the Licensing Authority, police and environmental health at least 10 working days (or 5 days in the event of a late notice) before the event is scheduled to take place by issuing a Temporary Event Notice (TEN). The event will be permitted to take place unless the Licensing Authority issues a counter notice.
- 3.3 The Licensing Authority can issue a counter notice if the number of permitted events has been exceeded or if, upon consideration of an 'objection notice' given by the police or those in the Council that exercise environmental health functions, it is satisfied that the event would undermine one or more of the licensing objectives.

- 3.4 If the police or those in the Council that exercise environmental health functions give an objection notice to the Licensing Authority, the Authority must convene a hearing to consider if it wishes to issue a counter notice. If the Authority determines to issue a counter notice it must give two copies to the premises user – a notice of its decision and a notice of the reasons for its decision. The decision must be made and the notices given at least 24 hours before the event is to begin. There is a right of appeal to the magistrates' court against the giving of a counter notice as a result of an objection notice

4. BACKGROUND

- 4.1 The premises is currently licensed under Licensing Act 2003 and a copy of the licence is attached as Appendix C.

5. TEMPORARY EVENT NOTICE FOR EVENT TO BE HELD 30/10/2021 - 01/11/2021

- 5.1 A TEN has been submitted to allow licensable activities to take place on the premises. A copy of the Temporary Event Notice and additional information is attached as Appendix A.

- 5.2 The Police have objected to the TEN on the grounds of the prevention of crime and disorder, public safety, public nuisance and protection of children from harm. A copy of the Police objection is attached as Appendix B.

6. HUMAN RIGHTS ACT 1998 IMPLICATIONS

- 6.1 There are implications for;

- **Article 6** – Right to a fair hearing
- **Article 14** – Not to discriminate
- Balancing; **Article 1**- Peaceful enjoyment of their possession (i.e. a licence is defined as being a possession) with **Article 8** – Right of Privacy (i.e. respect private & family life) to achieve a proportionate decision having regard to the protection of an individuals rights against the interests of the community at large.

7. MEMBERS DECISION MAKING

- A. **Option 1**
That the Licensing Authority decides not to give a counter notice.
- B. **Option 2**
That the Licensing Authority decides to give a counter notice, giving the reasons for the decision.

8. CONCLUSION

- 8.1 That Members decide whether or not to issue a counter notice for the event scheduled to take place on **30/10/2021** from **02:00am** finishing on **01/11/2021** at **05:00am** at location above.

Group Director, Neighbourhoods and Housing	Ajman Ali
Lead Officer (holder of original copy):	Shan Uthayasangar Licensing Officer Licensing Service 1 Hillman Street E8 1DY Telephone: 020 8356 2431

LIST OF BACKGROUND PAPERS RELATING TO THIS REPORT

The following document(s) has been relied upon in the preparation of the report.

Description of document	Location
Office File: The Munch, Ground Floor, 148 Shoreditch High Street, London, E1 6JE.	Licensing Service 1 Hillman Street London E8 1DY

Printed matter

Licensing Act 2003

LBH Statement of Licensing Policy

APPENDIX A



Temporary Event Notice

Before completing this notice, please read the guidance notes at the end of the notice. If you are completing this notice by hand, please write legibly in block capitals. In all cases, ensure that your answers are inside the boxes and written in black ink or typed. Use additional sheets if necessary. You should keep a copy of the completed notice for your records. You must send at least one copy of this notice to the licensing authority and additional copies must be sent to the chief officer of police and the local authority exercising environmental health functions for the area in which the premises are situated. The licensing authority will give to you written acknowledgement of the receipt of the notice.

I, the proposed premises user, hereby give notice under section 100 of the Licensing Act 2003 of my proposal to carry on a temporary activity at the premises described below.

1. The personal details of premises user (Please read note 1)			
1. Your name			
Title	Mr <input checked="" type="checkbox"/> Mrs <input type="checkbox"/> Miss <input type="checkbox"/> Ms <input type="checkbox"/> Other (please state)		
Surname	Disbudak		
Forenames	Utku		
2. Previous names (Please enter details of any previous names or maiden names, if applicable. Please continue on a separate sheet if necessary)			
Title	Mr <input type="checkbox"/> Mrs <input type="checkbox"/> Miss <input type="checkbox"/> Ms <input type="checkbox"/> Other (please state)		
Surname			
Forenames			
3. Your date of birth	Day	Month	Year
4. Your place of birth			
5. National Insurance Number			
6. Your current address (We will use this address to correspond with you unless you complete the separate correspondence box below)			
[Redacted Address]			
Post town		Postcode	
7. Other contact details			
Telephone numbers Daytime	[Redacted]		
Evening (optional)			
Mobile (optional)	[Redacted]		
Fax number (optional)			
E-Mail address (if available)	[Redacted]		

8. Alternative address for correspondence (If you complete the details below, we will use this address to correspond with you)	
Post town	Postcode
9. Alternative contact details (if applicable)	
Telephone numbers: Daytime	
Evening (optional)	
Mobile (optional)	
Fax number (optional)	
E-Mail address (if available)	

2. The premises	
Please give the address of the premises where you intend to carry on the licensable activities or, if it has no address, give a detailed description (including the Ordnance Survey references) (Please read note 2)	
The Munch, Ground Floor 148 Shoreditch High Street Hackney, London, E1 6JE	
Does a premises licence or club premises certificate have effect in relation to the premises (or any part of the premises)? If so, please enter the licence or certificate number below.	
Premises licence number	LBH-PRE-T-0910
Club premises certificate number	
If you intend to use only part of the premises at this address or intend to restrict the area to which this notice applies, please give a description and details below. (Please read note 3)	
The whole site will be used for this event. For all three events/dates, the restaurant will be open till 6am.	
Please describe the nature of the premises below. (Please read note 4)	
This is a Turkish restaurant.	
Please describe the nature of the event below. (Please read note 5)	
This event has been scheduled to celebrate Halloween.	

--

3. The licensable activities	
Please state the licensable activities that you intend to carry on at the premises (please tick all licensable activities you intend to carry on). (Please read note 6)	
The sale by retail of alcohol	<input type="checkbox"/>
The supply of alcohol by or on behalf of a club to, or to the order of, a member of the club	<input type="checkbox"/>
The provision of regulated entertainment (Please read note 7)	<input type="checkbox"/>
The provision of late night refreshment	<input checked="" type="checkbox"/>
Are you giving a late temporary event notice? (Please read note 8)	<input type="checkbox"/>
Please state the dates on which you intend to use these premises for licensable activities. (Please read note 9)	
Start Date: 30-10-2021, 31-10-2021, 01/11/2021	
Please state the times during the event period that you propose to carry on licensable activities (please give times in 24 hour clock). (Please read note 10)	
On the 30/10/2021 & 31/10/2021 the events will start at 4am and finish at 5am. On the 01/11/2021 the event will start at 2am and finish at 5am	
Please state the maximum number of people at any one time that you intend to allow to be present at the premises during the times when you intend to carry on licensable activities, including any staff, organisers or performers. (Please read note 11)	15
If the licensable activities will include the sale or supply of alcohol, please state whether these will be for consumption on or off the premises, or both (please tick as appropriate). (Please read note 12)	On the premises only <input type="checkbox"/>
	Off the premises only <input type="checkbox"/>
	Both <input checked="" type="checkbox"/>

<p>Please state if the licensable activities will include the provision of relevant entertainment. If so, please state the times during the event period that you propose to provide relevant entertainment (including, but not limited to lap dancing and pole dancing). (Please see note 13)</p> <p>N/A</p>

4. Personal licence holders (Please read note 14)		
Do you currently hold a valid personal licence? (Please tick)	Yes <input checked="" type="checkbox"/>	No <input type="checkbox"/>
If "Yes" please provide the details of your personal licence below.		
Issuing licensing authority	[REDACTED]	
Licence number	[REDACTED]	
Date of issue	[REDACTED]	
Any further relevant details	[REDACTED]	

5. Previous temporary event notices you have given (Please read note 15 and tick the boxes that apply to you)		
Have you previously given a temporary event notice in respect of any premises for events falling in the same calendar year as the event for which you are now giving this temporary event notice?	Yes <input type="checkbox"/>	No <input checked="" type="checkbox"/>
If answering yes, please state the number of temporary event notices (including the number of late temporary event notices, if any) you have given for events in that same calendar year		
Have you already given a temporary event notice for the same premises in which the event period: a) ends 24 hours or less before; or b) begins 24 hours or less after the event period proposed in this notice?	Yes <input type="checkbox"/>	No <input checked="" type="checkbox"/>

6. Associates and business colleagues (Please read note 16 and tick the boxes that apply to you)		
Has any associate of yours given a temporary event notice for an event in the same calendar year as the event for which you are now giving a temporary event notice?	Yes <input type="checkbox"/>	No <input checked="" type="checkbox"/>
If answering yes, please state the total number of temporary event notices (including the number of late temporary event notices, if any) your associate(s) have given for events in the same calendar year.		
Has any associate of yours already given a temporary event notice for the same premises in which the event period: a) ends 24 hours or less before; or b) begins 24 hours or less after the event period proposed in this notice?	Yes <input type="checkbox"/>	No <input checked="" type="checkbox"/>
Has any person with whom you are in business carrying on licensable activities given a temporary event notice for an event in the same calendar year as the event for which you are now giving a temporary event notice?	Yes <input type="checkbox"/>	No <input checked="" type="checkbox"/>
If answering yes, please state the total number of temporary event notices (including the number of late temporary event notices, if any) your business colleague(s) have given for events in the same calendar year.		

Has any person with whom you are in business carrying on licensable activities already given a temporary event notice for the same premises in which the event period: a) ends 24 hours or less before; or b) begins 24 hours or less after the event period proposed in this notice?	Yes <input type="checkbox"/>	No <input checked="" type="checkbox"/>
---	---------------------------------	---

7. Checklist (Please read note 17)	
I have: (Please tick the appropriate boxes, where applicable)	
Sent at least one copy of this notice to the licensing authority for the area in which the premises are situated	<input checked="" type="checkbox"/>
Sent a copy of this notice to the chief officer of police for the area in which the premises are situated	<input checked="" type="checkbox"/>
Sent a copy of this notice to the local authority exercising environmental health functions for the area in which the premises are situated	<input checked="" type="checkbox"/>
If the premises are situated in one or more licensing authority areas, sent at least one copy of this notice to each additional licensing authority	<input checked="" type="checkbox"/>
If the premises are situated in one or more police areas, sent a copy of this notice to each additional chief officer of police	<input checked="" type="checkbox"/>
If the premises are situated in one or more local authority areas, sent a copy of this notice to each additional local authority exercising environmental health functions	<input checked="" type="checkbox"/>
Made or enclosed payment of the fee for the application	<input checked="" type="checkbox"/>
Signed the declaration in Section 9 below	<input checked="" type="checkbox"/>

8. Condition (Please read note 18)
It is a condition of this temporary event notice that where the relevant licensable activities described in Section 3 above include the sale or supply of alcohol that all such supplies are made by or under the authority of the premises user.

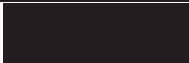
9. Declarations (Please read note 19)	
The information contained in this form is correct to the best of my knowledge and belief.	
I understand that it is an offence: (i) to knowingly or recklessly make a false statement in or in connection with this temporary event notice and that a person is liable on summary conviction for such an offence to a fine of any amount; and (ii) to permit an unauthorised licensable activity to be carried on at any place and that a person is liable on summary conviction for any such offence to a fine of any amount, or to imprisonment for a term not exceeding six months, or to both.	
Signature	
Date	14/10/2021

Name of Person signing	Ozlem Has
------------------------	-----------

For completion by the licensing authority

10. Acknowledgement (Please read note 20)	
I acknowledge receipt of this temporary event notice.	
Signature	On behalf of the licensing authority
Date	
Name of Officer signing	

APPENDIX B

RESPONSIBLE AUTHORITY REPRESENTATION: APPLICATION UNDER THE LICENSING ACT 2003

RESPONSIBLE AUTHORITY DETAILS

NAME OF AUTHORITY	Metropolitan Police service
ADDRESS OF AUTHORITY	Licensing Unit, Stoke Newington Police Station 33 Stoke Newington High Street Stoke Newington London N16 8DS
CONTACT NAME	PC590GD Hunwick
TELEPHONE NUMBER	0207 275 3146
E-MAIL ADDRESS	hackneylicensing@met.police.uk

APPLICATION PREMISES

NAME & ADDRESS OF PREMISES	The Munch 148 Shoreditch High Street London E1 6JE
NAME OF PREMISES USER	Utku Disbudak

COMMENTS

I make the following relevant representations in relation to the above application to the TEN at the above address.

- 1) the prevention of crime and disorder ◆
- 2) public safety ◆
- 3) the prevention of public nuisance ◆
- 4) the protection of children from harm

Representations (which include comments and/or objections) in relation to:



This premises licence has been issued by:

Licensing Service
1 Hillman Street
London E8 1DY

PART A – PREMISES LICENCE

Premises Licence Number

LBH-PRE-T-0910

Part 1 – Premises details

The Munch
Ground Floor
148 Shoreditch High Street
Hackney
London
E1 6JE

020 7613 3277

Where the licence is time limited the dates

Not Applicable

Licensable activities authorised by the licence

Late Night Refreshment
Supply of Alcohol

The times the licence authorises the carrying out of Licensable activities

**Late Night
Refreshment**

Standard Hours:

Premises:

Mon 23:00-02:00
Tue 23:00-02:00
Wed 23:00-02:00
Thu 23:00-02:00
Fri 23:00-04:00
Sat 23:00-04:00
Sun 23:00-02:00

Supply of Alcohol Standard Hours:

Premises:

Mon 11:00-23:00
Tue 11:00-23:00
Wed 11:00-23:00
Thu 11:00-23:00
Fri 11:00-23:00
Sat 11:00-23:00
Sun 11:00-23:00

The opening hours of the premises

Standard Hours:

Mon 11:00-02:00
Tue 11:00-02:00
Wed 11:00-02:00
Thu 11:00-02:00
Fri 11:00-04:00
Sat 11:00-04:00
Sun 11:00-02:00

Where the licence authorises supplies of alcohol whether these are on and/or off supplies

On Premises

Part 2 –

Name, (registered) address, telephone number and e-mail (where relevant) of holder of premises licence

Utku Disbudak

[REDACTED]
[REDACTED]
[REDACTED]

Registered number of holder, for example company number, charity number (where applicable)

N/A

Name, address and telephone number of designated premises supervisor where the premises authorises the supply of alcohol

Utku Disbudak

Personal licence number and issuing authority of personal licence held by designated premises supervisor where the premises licence authorises the supply of alcohol

Date of Grant: 6 February 2008

Signed:

**David Tuitt
Team Leader - Licensing**

Annex 1 - Mandatory Conditions

Supply of Alcohol

Mandatory condition for Supply of Alcohol (On/Both):

1. No supply of alcohol may be made under the premises licence:
 - (a) At a time when there is no designated premises supervisor in respect of the premises licence.
 - (b) At a time when the designated premises supervisor does not hold a personal licence or his personal licence is suspended.
2. Every supply of alcohol under the premises licence must be made or authorised by a person who holds a personal licence.
3.
 - (1) The responsible person must ensure that staff on relevant premises do not carry out, arrange or participate in any irresponsible promotions in relation to the premises.
 - (2) In this paragraph, an irresponsible promotion means any one or more of the following activities, or substantially similar activities, carried on for the purpose of encouraging the sale or supply of alcohol for consumption on the premises -
 - (a) games or other activities which require or encourage, or are designed to require or encourage, individuals to;
 - (i) drink a quantity of alcohol within a time limit (other than to drink alcohol sold or supplied on the premises before the cessation of the period in which the responsible person is authorised to sell or supply alcohol), or
 - (ii) drink as much alcohol as possible (whether within a time limit or otherwise);
 - (b) provision of unlimited or unspecified quantities of alcohol free or for a fixed or discounted fee to the public or to a group defined by a particular characteristic in a manner which carries a significant risk of undermining a licensing objective;
 - (c) provision of free or discounted alcohol or any other thing as a prize to encourage or reward the purchase and consumption of alcohol over a period of 24 hours or less in a manner which carries a significant risk of undermining a licensing objective;
 - (d) selling or supplying alcohol in association with promotional posters or flyers on, or in the vicinity of, the premises which can reasonably be considered to condone, encourage or glamorise anti-social behaviour or to refer to the effects of drunkenness in any favourable manner.

- (e)dispensing alcohol directly by one person into the mouth of another (other than where that other person is unable to drink without assistance by reason of a disability).
4. The responsible person must ensure that free potable water is provided on request to customers where it is reasonably available.
 - 5.5.1. The premises licence holder or club premises certificate holder must ensure that an age verification policy is adopted in respect of the premises in relation to the sales or supply of alcohol.
 - 5.2 The designated premises supervisor in relation to the premises licences must ensure that the supply of alcohol at the premises is carried on in accordance with the age verification policy.
 - 5.3. The policy must require individuals who appear to the responsible person to be under 18 years of age (or such older age as may be specified in the policy) to produce on request, before being served alcohol, identification bearing their photograph, date of birth and either:-
 - (a) a holographic mark or
 - (b) an ultraviolet feature
 6. The responsible person must ensure that:
 - a) where any of the following alcoholic drinks is sold or supplied for consumption on the premises (other than alcoholic drinks sold or supplied having been made up in advance ready for sale or supply in a securely closed container) it is available to customers in the following measures:
 - beer or cider:1/2 pint;
 - gin, rum, vodka or whisky: 25ml or 35ml; and
 - still wine in a glass: 125ml; and
 - b) these measures are displayed in a menu, price list or other printed material which is available to customers on the premises; and
 - c)where a customer does not in relation to a sale of alcohol specify the quantity of alcohol to be sold, the customers is made aware that these measures are available.

Minimum Drinks Pricing

7. 7.1 A relevant person shall ensure that no alcohol is sold or supplied for consumption on or off the premises for a price which is less than the permitted price.

7.2 For the purposes of the condition set out in paragraph 7.1 above

(a) “duty” is to be construed in accordance with the Alcoholic Liquor Duties Act 1979;

(b) “permitted price” is the price found by applying the formula -

$$P = D+(D \times V)$$

Where -

(i) P is the permitted price,

(ii) D is the rate of duty chargeable in relation to the alcohol as if the duty were charged on the date of the sale or supply of the alcohol, and

(iii) V is the rate of value added tax chargeable in relation to the alcohol as if the value added tax were charged on the date of the sale or supply of the alcohol;

(c) “relevant person” means, in relation to premises in respect of which there is in force a premises licence -

(i) the holder of the premises licence,

(ii) the designated premises supervisor (if any) in respect of such a licence, or

(iii) the personal licence holder who makes or authorises a supply of alcohol under such a licence;

(d) “relevant person” means, in relation to premises in respect of which there is in force a club premises certificate, any member or officer of the club present on the premises in a capacity which enables the member or officer to prevent the supply in question; and

(e) “value added tax” means value added tax charged in accordance with the Value Added Tax Act 1994.

7.3 Where the permitted price given by Paragraph 7.2(b) above would (apart from this paragraph) not be a whole number of pennies, the price given by that sub-paragraph shall be taken to be the price actually given by that sub-paragraph rounded up to the nearest penny.

7.4 (1) Sub-paragraph 7.4(2) below applies where the permitted price given by Paragraph 7.2(b) above on a day (“the first day”) would be different from the permitted price on the next day (“the second day”) as a result of a change to the rate of duty or value added tax.

(2) The permitted price which would apply on the first day applies to sales or supplies of alcohol which take place before the expiry of the period of 14 days beginning on the second day.

Annex 2 – Conditions consistent with the Operating Schedule

8. The management of the premises shall take part in local crime reduction schemes.
9. Alcohol shall only be supplied with seated table meals.
10. A register of refused sales shall be kept and maintained at the premises.
11. Staff shall be trained with regards to laws regarding under 18 year olds & alcohol sales.
12. 'Challenge 21' notices shall be displayed at the premises.

Conditions derived from Responsible Authority representations

13. Bins must not be discharged between 11p.m. and 7a.m.
14. Notices must be prominently displayed at the exits reminding patrons to depart in an orderly manner.

Annex 3 – Conditions attached after a hearing by the licensing authority

None

Annex 4 – Plans

PLAN/LBH-PER-T-0910/070316

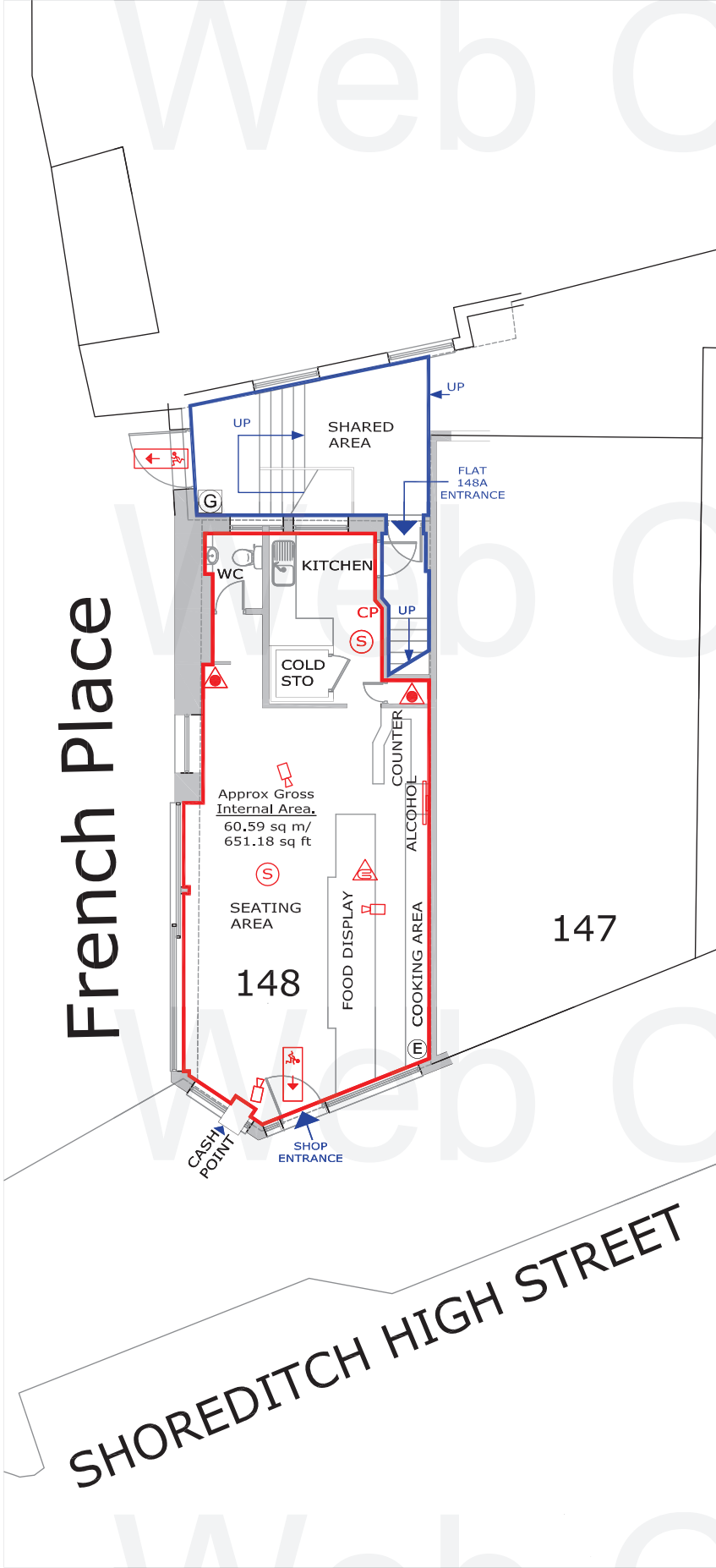
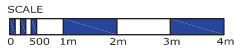

French Place

Approx Gross Internal Area,
60.59 sq m/
651.18 sq ft

148

147

SHOREDITCH HIGH STREET

GROUND FLOOR PLAN
SCALE 1:100



LOCATION PLAN
SCALE 1:1250



KEY

- CCTV
- FIRE EXTINGUISHER - WATER
- FIRE ALARM CALL POINT
- SMOKE DETECTOR
- FIRE EXIT
- FIRE ALARM SOUNDER
- FIRE BLANKET
- FIRE EXTINGUISHER - CARBON DIOXIDE
- FIRE EXTINGUISHER - DRY POWDER
- FIRE EXTINGUISHER - FOAM
- CCTV MONITOR SCREEN
- HEAT DETECTOR
- GAS METER
- ELECTRIC METER

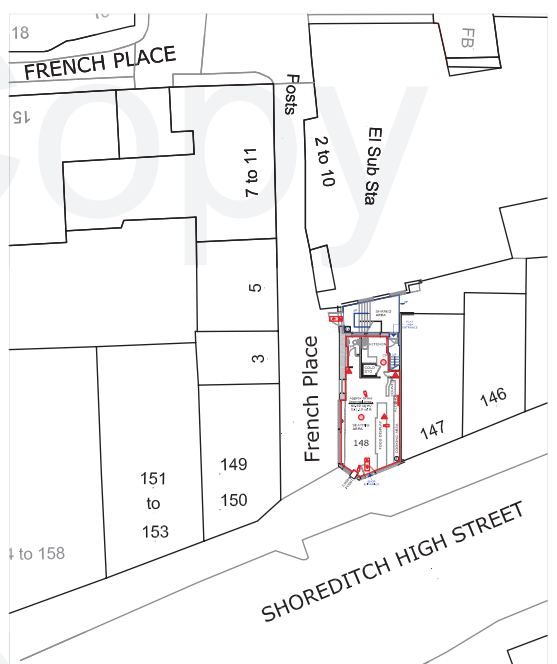

BLOCK PLAN
SCALE 1:500

client	address	location	date	scale	sheet
	148 SHOREDITCH HIGH STREET LONDON E1 6JE	LICENSING PLAN	12-AUG-2015	1:100	A3
			dwg. no.	revision	
			BC27L-01		

Boham Consult Limited
191 Lawrence Avenue
London E12 5QR
Tel: 08450523724
Fax: 02082226990
info@bohamconsult.com
www.londonfirelicensing.com

APPENDIX D



Scale: 1:1250 at A4

The Munch, Ground Floor, 148 Shoreditch High Street, E1 6JE



Ref:
Thursday, October 21, 2021

Produced by: unspecified
email:

please specify copyright statement